

Pin数	尺寸A	尺寸B
2	4.20	5.50
3	8.40	9.70
4	12.60	13.90
5	16.80	22.30
6	21.00	26.50
7	25.20	30.70
8	29.40	34.90
9	33.60	39.10
10	37.80	43.30
11	42.00	47.50
12	46.20	51.70

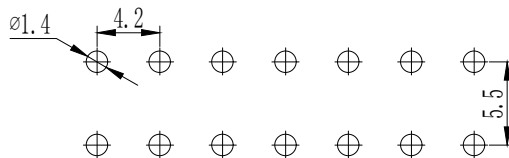

P. C. B LAYOUT

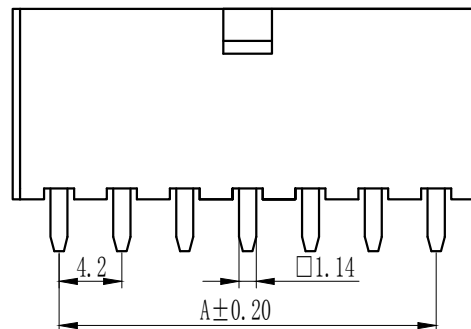
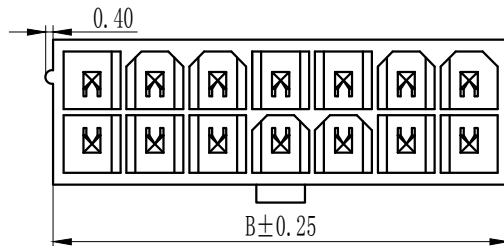
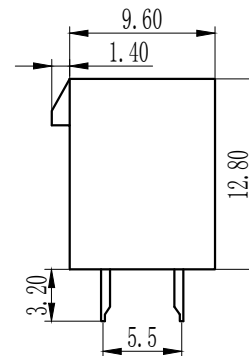

技术参数 SPECIFICATIONS

- ◆ 间距: 4.2 Pitch:4.2
- ◆ 适用线规: AWG#22-#28
Applicable Wire:AWG#22-#28
- ◆ 额定电压: AC,DC, 250V (有效值)
Voltage rating: AC,DC, 250V(rms)
- ◆ 额定电流: 5A, AC, DC
Current rating:5A, AC, DC
- ◆ 耐压值: 1500V AC/minute
Withstand voltage:1500V AC/minute
- ◆ 工作温度: -25℃~+85℃
Working Temp:-25℃~+85℃
- ◆ 绝缘电阻: $\geq 1000M\Omega$
Insulation resistance: $\geq 1000M\Omega$
- ◆ 接触电阻: $\leq 20m\Omega$
Contact resistance: $\leq 20m\Omega$

材料 MATERIAL

- ◆ 绝缘体: 尼龙66, UL94-2
Insulator:Nylon66 UL94-2
- ◆ 接触针: 磷青铜
Contact PIN: Phosphor Bronze

TOLERANCE:

X. $\pm XXX$

.X ± 0.20

.XX ± 0.10

ANG.



上海狮拓电子科技有限公司

产品名称:

产品料号:

THIRD ANGLE PROJECTION



签名 _____

日期 _____

审核 _____

日期 _____

客户确认

承认 _____ 日期 _____

取回 _____ 日期 _____

5566-nA