

Pin数	尺寸A	尺寸B	尺寸C
2	2.50	5.70	7.50
3	5.0	8.20	10.00
4	7.50	10.70	12.50
5	10.00	13.20	15.00
6	12.50	15.70	17.50
7	15.00	18.20	20.00
8	17.50	20.70	22.50
9	20.00	23.20	25.00
10	22.50	25.70	27.50
11	25.00	28.20	30.00
12	27.50	30.70	32.50
13	30.00	33.20	35.00
14	32.50	35.70	37.50
15	35.00	38.20	40.00
16	37.50	40.70	42.50

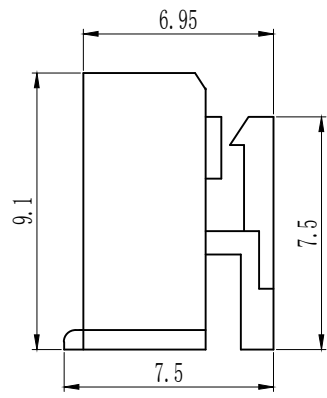
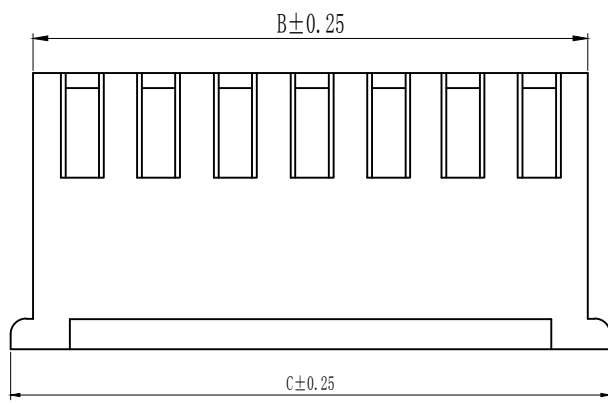
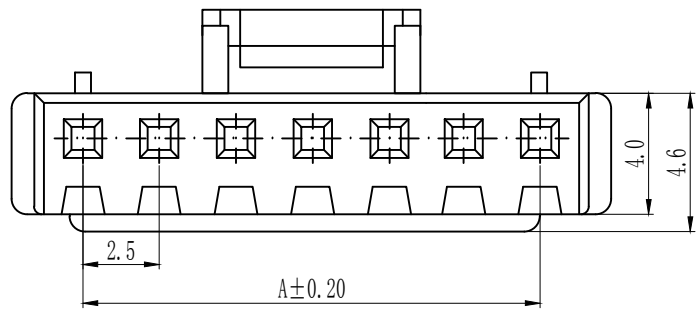

技术参数 SPECIFICATIONS

- ◆间距: 2.5 Pitch:2.5
- ◆适用线规: AWG#22-#30  
Applicable Wire:AWG#22-#30
- ◆额定电压: AC,DC, 250V (有效值)  
Voltage rating: AC, DC, 250V(rms)
- ◆额定电流: 3A, AC, DC (AWG#22)  
Current rating:3A, AC, DC (AWG#22)
- ◆耐压值: 1000V AC/minute  
Withstand voltage:1000V AC/minute
- ◆工作温度: -25℃~+85℃  
Working Temp:-25℃~+85℃
- ◆绝缘电阻: ≥1000MΩ  
Insulation resistance:≥1000MΩ
- ◆接触电阻: ≤0.02mΩ  
Contact resistance:≤0.02mΩ

材料 MATERIAL

- ◆绝缘体: 尼龙66, UL94-V0  
Insulator:Nylon66 UL94-V0

TOLERANCE:
X. ±XXX
.X ±0.20
.XX ±0.10
ANG.

**STO** 上海狮拓电子科技有限公司

产品名称: \_\_\_\_\_

产品料号: \_\_\_\_\_

THIRD ANGLE PROJECTION

客户确认

签名: \_\_\_\_\_

日期: \_\_\_\_\_

审核: \_\_\_\_\_

日期: \_\_\_\_\_

承認 \_\_\_\_\_ 日期 \_\_\_\_\_

駁回 \_\_\_\_\_ 日期 \_\_\_\_\_

XHS-NY