

Pin数	尺寸A	尺寸B
2	1.50	4.50
3	3.0	6.0
4	4.50	7.50
5	6.00	9.00
6	7.50	10.50
7	9.00	12.00
8	10.50	13.50
9	12.00	15.00
10	13.50	16.50
11	15.00	18.00
12	16.50	19.50
13	18.00	21.00
14	19.50	22.55
15	21.00	24.00
16	22.50	25.50

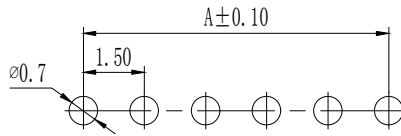
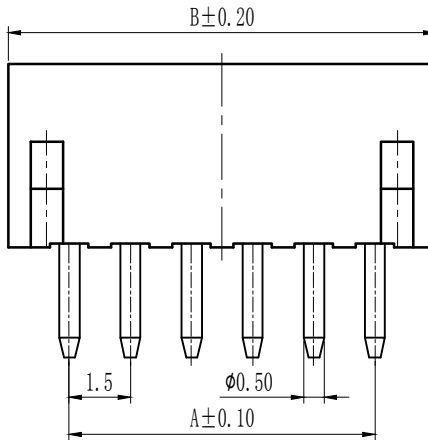
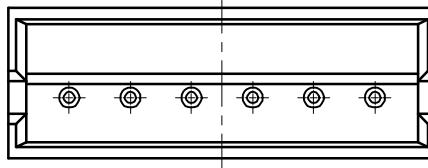
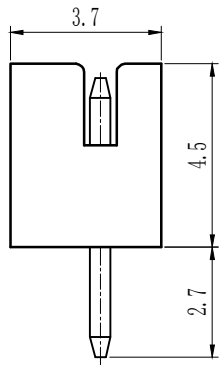

P. C. B LAYOUT

技术参数 SPECIFICATIONS

- ◆间距: 1.5 Pitch:1.5
- ◆适用线规: AWG#26-#32
Applicable Wire:AWG#26-#32
- ◆额定电压: AC, DC, 50V (有效值)
Voltage rating: AC, DC, 50V(rms)
- ◆额定电流: 1A, AC, DC (AWG#28)
Current rating: 1A, AC, DC (AWG#28)
- ◆耐压值: 500V AC/minute
Withstand voltage:500V AC/minute
- ◆工作温度: -25℃~+85℃
Working Temp:-25℃~+85℃
- ◆绝缘电阻: ≥500MΩ
Insulation resistance:≥500MΩ
- ◆接触电阻: ≤20mΩ
Contact resistance:≤20mΩ

材料 MATERIAL

- ◆绝缘体: 尼龙46, UL94-V0
Insulator:PA46, UL94-V0
- ◆接触针: 黄铜
Contact PIN:Brass

TOLERANCE:

X. ±XXX

.X ±0.20

.XX ±0.10

ANG.



上海狮拓电子科技有限公司

产品名称:

产品料号:

THIRD ANGLE PROJECTION



签名 _____

日期 _____

审核 _____

日期 _____

客户确认

承認 _____ 日期 _____

取回 _____ 日期 _____

ZH1.5T-1-NA