

A
B
C
D
E
F
G
H
I
J

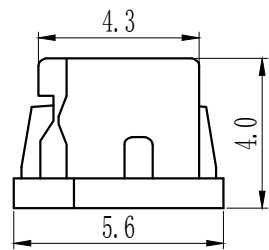
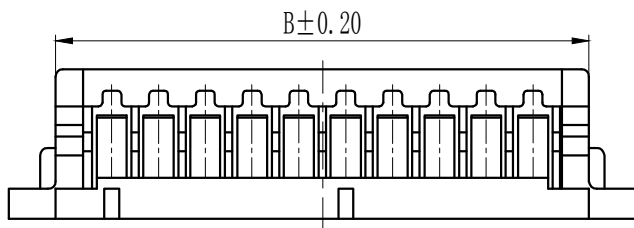
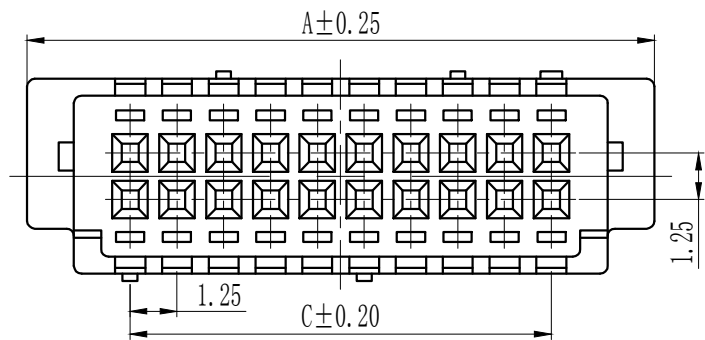

Poles	A	B	C
5Y	10.50	8.00	5.00
10Y	16.75	14.25	11.25
15Y	23.00	20.50	17.50
20Y	29.25	26.75	23.75
25Y	35.50	33.00	30.00

技术参数 SPECIFICATIONS

- ◆适用线规: AWG#26~#30
Applicable Wire: AWG#26~#30
- ◆额定电压: 150V DC, AC(rms)
Rated voltage: 150V DC, AC(rms)
- ◆额定电流: 1A(AWG #26)
Rated Current: 1A(AWG #26)
- ◆耐压值: 500V AC/minute
Withstand voltage: 500V AC/min
- ◆工作温度: -35°C~+85°C
Working Temp:-35°C~+85°C
- ◆绝缘电阻: 500MΩ Min
Insulation resistance: ≥500MΩ
- ◆接触电阻: ≤30mΩ
Contact resistance: ≤30mΩ

材料 MATERIAL

- ◆绝缘体: PBT, UL94-V0
Insulator: PBT, UL94-V0

TOLERANCE:
X. ±XXX
.X ±0.20
.XX ±0.10
ANG.

STO 上海狮拓电子科技有限公司

产品名稱: _____

产品料號: _____

THIRD ANGLE PROJECTION

簽名 _____	客戶確認
日期 _____	
審核 _____	
日期 _____	
<input type="checkbox"/> 承認 _____ 日期 _____	
<input type="checkbox"/> 駁回 _____ 日期 _____	

1.25T-2-DF13-2×NY