

ROHS

页码	文件编号
1 OF 1	ST0-C0-037A

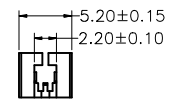
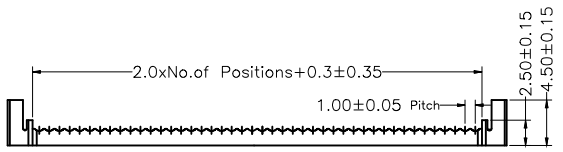
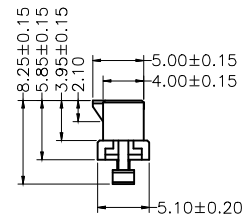
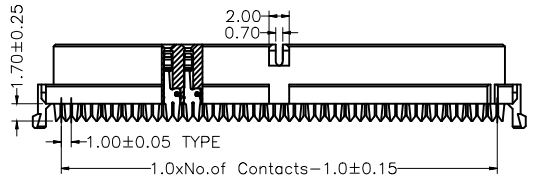
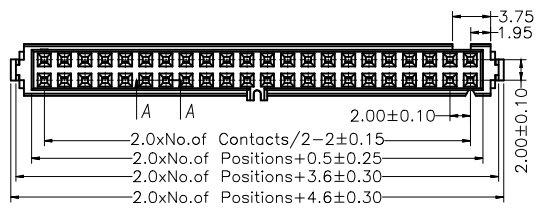

■ Specifications(规格) :

- Current rating(额定电流): 1A AC / DC
- Withstanding voltage(耐压值): 500V AC/minute
- Temperature range(工作温度): -40°C~+105°C
- Insulation resistance(绝缘电阻):  $\geq 1000M\Omega$
- Contact resistance(接触电阻):  $\leq 20m\Omega$

■ IDC

- Part No. (料号) : 4200IYXXBKPTH01S2T
- Poles (PIN数) : 06-50P
- Material (材质) : PBT+30% Glass Fiber (UL94V-0).

Pin针: Phosphor Bronze (磷青铜)  
 Finish (电镀) : Contact-Plated (接触点镀金)  
 Bottom-Nickel (底部镀镍)

4200 I Y XX BK PT H01- S2 X

- ① 系列
- ② 类别: I-DC类
- ③ 外观形态:  
N- 无鼻 Y-有鼻
- ④ PIN数:  
X X
- ⑤ 颜色:  
BK - 黑色 GY - 灰色
- ⑥ 材质:  
6 T - PA 6 T 9 T - PA 9 T 4 6 - PA 4 6  
T S - 其它
- ⑦ 电镀类别: G \* \* - 镀金 V \* \*H\* 镀全镀半金  
 \* 0 1 - 1 U " \* 0 2 - 2 U " \* 0 3 - 3 U "  
 \* 1 0 - 1 0 U " \* 1 5 - 1 5 U " \* 3 0 - 3 0 U "  
 N - 镀镍 ( 3 0 - 5 0 U " ) S N - 镀亮锡 ( 0  
 S N 1 - 镀亮锡 ( 1 2 0 U " M i n . ) S - 镀银  
 S W - 镀雾锡 H S - 高温锡
- ⑧ 成品的件数  
S2-二件式 S3-三件式
- ⑨ 空PIN位置及特殊码:  
T-T Type

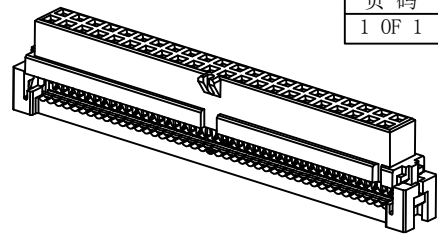

DIM E N S I S			
Position	A	B	C
06	10.60	5.00	4.00
08	12.60	7.00	6.00
10	14.60	9.00	8.00
12	16.60	11.00	10.00
14	18.60	13.00	12.00
16	20.60	15.00	14.00
18	22.60	17.00	16.00
20	24.60	19.00	18.00
22	26.60	21.00	20.00
24	28.60	23.00	22.00
26	30.60	25.00	24.00
28	32.60	27.00	26.00
30	34.60	29.00	28.00
32	36.60	31.00	30.00
34	38.60	33.00	32.00
36	40.60	35.00	34.00
38	42.60	37.00	36.00
40	44.60	39.00	38.00
42	46.60	41.00	40.00
44	48.60	43.00	42.00
46	50.60	45.00	44.00
48	52.60	47.00	46.00
50	54.60	49.00	48.00

TOLERANCE:
X. ±XXX
.X ±0.20
.XX ±0.10
ANG.

	上海狮拓电子科技有限公司	
	产品名稱:	
	产品料號:	

簽名 _____	客戶確認
日期 _____	
審核 _____	<input type="checkbox"/> 承認 _____ 日期 _____
日期 _____	<input type="checkbox"/> 駁回 _____ 日期 _____

4200IYXXBKPTH01S2T  
 XXP 2.0mm MFT 二件有凸半金1U

THIRD ANGLE PROJECTION