

ROHS

页码	文件编号
1 OF 1	ST0-C0-040

■ Specifications(规格) :

- Current rating(额定电流): 1AMP
- Withstanding voltage(耐压值): 500V AC/DC
- Temperature range(工作温度): -40°C~+105°C
- Insulation resistance(绝缘电阻): ≥1000MΩ
- Contact resistance(接触电阻): ≤20mΩ

■ I DC

- Part No. (料号) : 4200IYXXBKPTH01S2S
- Poles (PIN数) : 06-60P
- Material (材质) : PBT Glass Fiber (UL94V-0).
Pin针: Phosphor Bronze (磷青铜)
Finish (电镀) : Au Over Ni (接触点镀金)
Bottom-Nickel (底部镀镍)

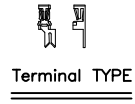
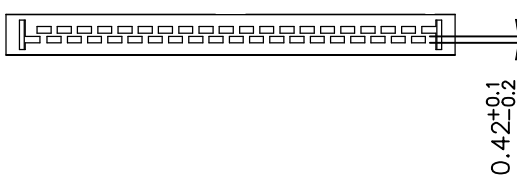
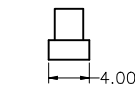
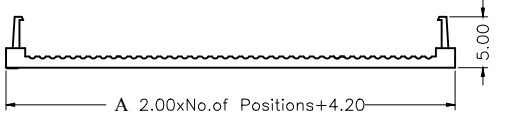
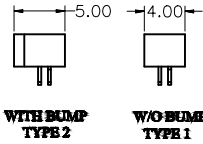
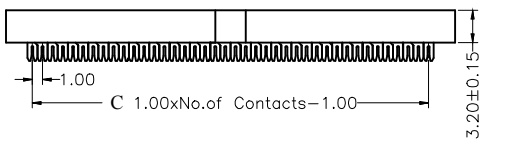
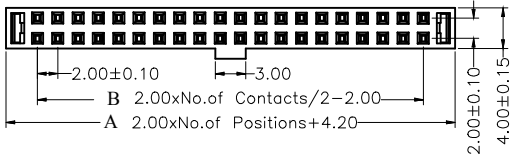
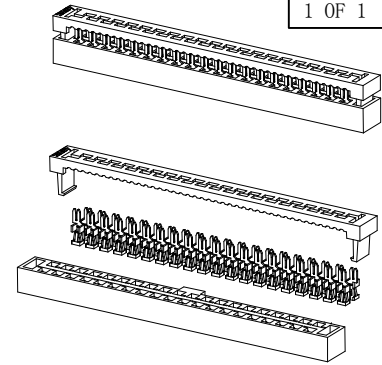

4200 I Y XX BK PT H01-S2 S
① ② ③ ④ ⑤ ⑥ ⑦ ⑧ ⑨

- ① 系列
- ② 类别: I-DC类
- ③ 外观形态:
N- 无鼻 Y-有鼻
- ④ PIN数:
X X P位
- ⑤ 颜色:
BK - 黑色 GY - 灰色
- ⑥ 材质:
6 T - PA 6 T 9 T - PA 9 T 4 6 - PA 4 6 L P - C P
T S - 其它
- ⑦ 电镀类别: G * * - 镀金 V * * H * 镀全镀半金
* 0 1 - 1 U " * 0 2 - 2 U " * 0 3 - 3 U "
* 1 0 - 1 0 U " * 1 5 - 1 5 U " * 3 0 - 3 0 U "
N - 镀镍 (3 0 - 5 0 U ") S N - 镀亮锡 (7
S N 1 - 镀亮锡 (1 2 0 U " M i n .) S - 镀银
S W - 镀雾锡 H S - 高温锡
- ⑧ 成品的件数
S2-二件式 S3-三件式
- ⑨ 空PIN位置及特殊码:
S-主体为矮体

DIM E N S I O N S			
Position	A	B	C
06	10.20	4.00	5.00
08	12.20	6.00	7.00
10	14.20	8.00	9.00
12	16.20	10.00	11.00
14	18.20	12.00	13.00
16	20.20	14.00	15.00
18	22.20	16.00	17.00
20	24.20	18.00	19.00
22	26.20	20.00	21.00
24	28.20	22.00	23.00
26	30.20	24.00	25.00
28	32.20	26.00	27.00
30	34.20	28.00	29.00
32	36.20	30.00	31.00
34	38.20	32.00	33.00
36	40.20	34.00	35.00
38	42.20	36.00	37.00
40	44.20	38.00	39.00
42	46.20	40.00	41.00
44	48.20	42.00	43.00
46	50.20	44.00	45.00
48	52.20	46.00	47.00
50	54.20	48.00	49.00
60	64.20	58.00	59.00

TOLERANCE:

X. ±XXX
.X ±0.20
.XX ±0.10
ANG.

ST 上海狮拓电子科技有限公司

產品名稱: _____

產品料號: _____

THIRD ANGLE PROJECTION

簽名 _____

日期 _____

審核 _____

日期 _____

客戶確認

承認 _____ 日期 _____

駁回 _____ 日期 _____

4200IYXXBKPTH01S2S

XXP 2.0mm MFS 二件有凸半金1U(H5.1)